

Directions to the temporary office of Laurie Marks and Victoria Kingsley

- ① Take the main elevator of Wheatley to the 4th floor.
- ② Turn left ^{WHEN YOU COME OUT OF ELEVATOR} and walk about a mile, until the hall ends in a lobby/waiting room.
- ③ Go into that lobby; turn left, and go through two sets of glass double doors.
- ④ Cross the hall and enter the area identified as "CPCS faculty and staff" (yellow sign overhead)
- ⑤ Turn left and look for room 06, which will be on your left.

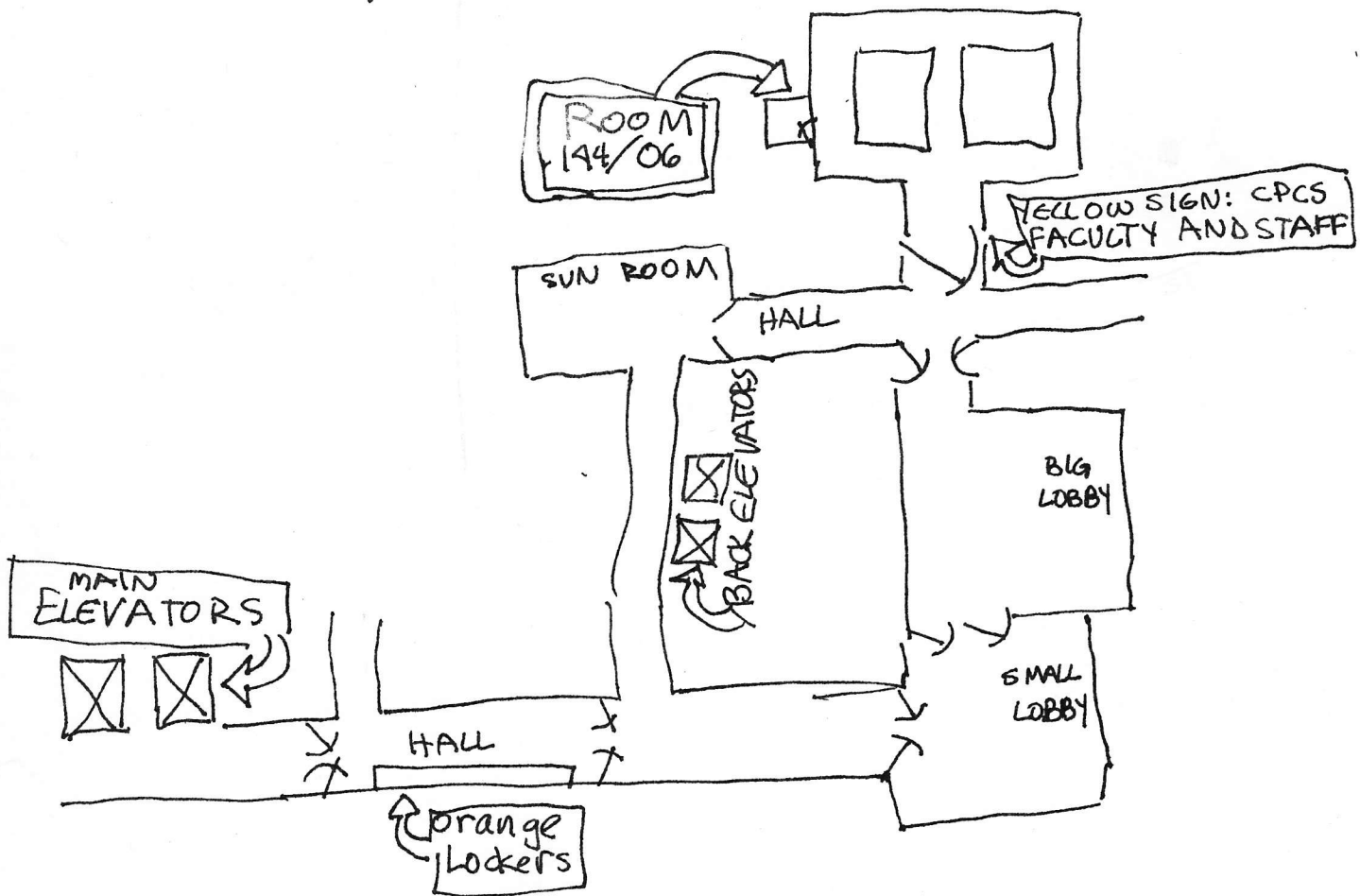

WHEATLEY 4TH FLOOR